

FLOOR ATLANTIC . CONGRESS CENTRE

Audiovisual equipment integrated in the conference rooms
(against payment)

Built-in voice and audio sound system in all conference rooms

Screens:

- 4 Built-in screens 4 m x 3 m

LCD Projectors:

- 4 Wireless WUXGA 3LCD Laser Projectors (6.000 lumens)

Support infrastructures services available:

- 2 Portable screens 2,5 m x 2,5 m
- 2 Portable Projectors
- 8 Wireless handheld microphones
- 4 Wireless headset microphones
- 4 Wireless clip microphones
- WI-FI in public areas and meeting rooms
- Flip charts
- Laser pointers
- Remote control for curtains
- Reception facilities for groups
- Direct access for buses
- Digital signposting to guide delegates
- Exclusive area for secretarial services



	Area	Dimensions	Height	Capacity					
				Theatre	Classroom 1 pax/table	Cabaret 3 pax/table	U shape 1 pax/table	Banquet 5 pax/table	Cocktail
ATLANTIC + Foyer	1029 m ²	10,7 m x 25,65 m 25 m x 30,2 m	4,2 m	257	196	183	34	305	326
ATLANTIC + I + II + III	755 m ²	25 m x 30,2 m	4,2 m	216	170	144	30	240	220
ATLANTIC I	247 m ²	25 m x 9,9 m	4,2 m	54	40	42	14	100	80
ATLANTIC II	263 m ²	25 m x 10,5 m	4,2 m	54	40	42	14	100	80
ATLANTIC III	245 m ²	25 m x 9,8 m	4,2 m	54	40	42	14	100	80
ATLANTIC I + 1/2 II	378,5 m ²	25 m x 15 m	4,2 m	90	70	57	20	130	110
ATLANTIC III + 1/2 II	376,5 m ²	25 m x 14,9 m	4,2 m	90	70	57	20	130	110
ATLANTIC I + II	510 m ²	25 m x 20,4 m	4,2 m	108	80	60	22	140	120
ATLANTIC II + III	508 m ²	25 m x 20,3 m	4,2 m	108	78	60	22	140	118
Foyer ATLANTIC	346 m ²	10,7 m x 25,65 m 4,7 m x 15,25 m	4,2 m	-	-	-	-	-	110

On the Theater / Classroom / Cabaret set up's, minimum areas for top table, lectern and frontal projection have been already considered.

FLOOR PACIFIC . CONGRESS CENTRE

Audiovisual equipment integrated in the conference rooms (against payment)

Built-in voice and audio sound system in 3 conference rooms

Screens:

- 5 Built-in screens 4 m x 3 m

LCD Projectors:

- 5 Wireless WUXGA 3LCD Laser Projectors (6.000 lumens)

Support infrastructures services available:

- 2 Portable screens 2,5 m x 2,5 m
- 2 Portable Projectors
- 8 Wireless handheld microphones
- 4 Wireless headset microphones
- 4 Wireless clip microphones
- Wi-Fi in public areas and meeting rooms
- Flip charts
- Laser pointers
- Remote control for curtains
- Reception facilities for groups
- Digital signposting to guide delegates
- Exclusive area for secretarial services

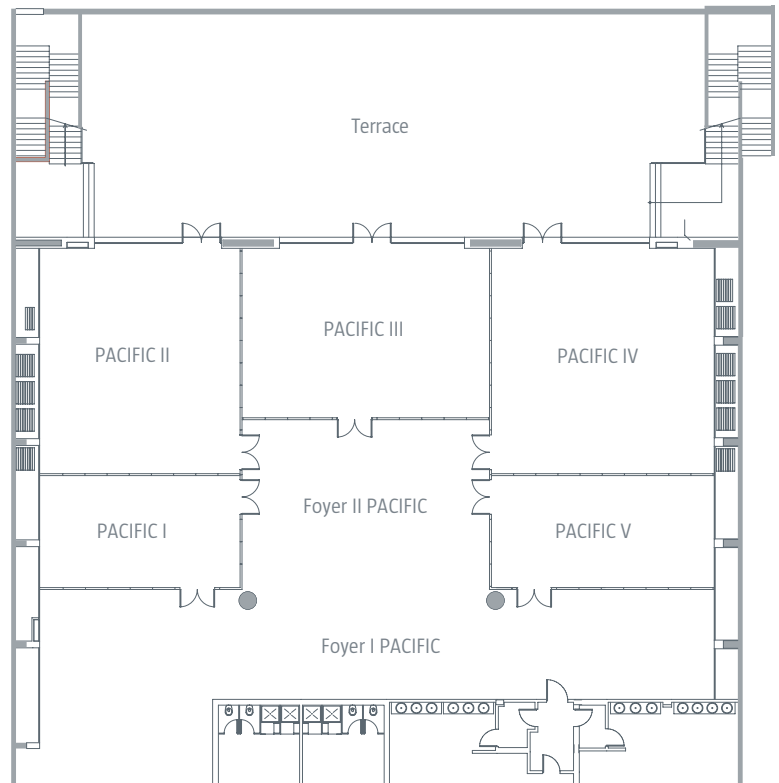

	Area	Dimensions	Height	Capacity					
				Theatre	Classroom 1 pax/table	Cabaret 3 pax/table	U shape 1 pax/table	Banquet 5 pax/table	Cocktail
PACIFIC I	62 m ²	5,8 m x 10,7 m	4,2 m	16	10	12	7	20	31
PACIFIC II	126 m ²	11,75 m x 10,7 m	4,2 m	28	20	27	11	45	63
PACIFIC III	114,5 m ²	8,85 m x 12,9 m	4,2 m	25	15	24	12	40	57
PACIFIC IV	132 m ²	11,75 m x 11,25 m	4,2 m	28	20	27	11	45	66
PACIFIC V	66 m ²	5,8 m x 11,25 m	4,2 m	16	10	12	7	20	33
Foyer I PACIFIC	199,5 m ²	5,7 m x 35 m	4,2 m	-	-	-	-	-	65
Foyer II PACIFIC	114 m ²	8,8 m x 12,95 m	4,2 m	-	-	-	-	-	57
PACIFIC's + Foyer I + II	819 m ²	23,4 m x 35 m	4,2 m	161	150	144	32	240	250
PACIFIC's + Foyer II	619,5 m ²	17,7 m x 35 m	4,2 m	187	120	117	32	195	180
PACIFIC I + II + III + Foyer II	416,5 m ²	17,55 m x 23,6 m	4,2 m	88	78	75	24	160	120
PACIFIC III + IV + V + Foyer II	426,5 m ²	17,55 m x 24,15 m	4,2 m	88	78	75	24	160	125
PACIFIC TERRACE	360 m ²	N/A	4,2 m	-	-	-	-	-	110
PACIFIC I + II	188 m ²	17,55 m x 10,7 m	4,2 m	44	30	30	15	50	55
PACIFIC IV + V	198 m ²	17,55 m x 11,25 m	4,2 m	48	33	33	16	55	60

On the Theater / Classroom / Cabaret set up's, minimum areas for top table, lectern and frontal projection have been already considered.